

Keystone Lintels

STEEL LINTELS

50-70MM CAVITY

P/K-50

Manufactured length	600	1350	1650	1950	2250	2550	2850	3150	3750	4200
150mm increments	1200	1500	1800	2100	2400	2700	3000	3600	4000	4800
Height 'h'	79	95	110	134	150	172	172	209	209	209
Thickness	1.6	2	2	2	2	2	2.6	3.2	3.2	3.4
Total UDL 3:1 kn	12	14	19	21	21	26	27	27	26	27
Total UDL 19:1 kn	10	12	16	17	19	22	20	20	19	22

S/K-50

Manufactured length	600	1350	1650	1950	2250	2550	2850	3150	3750	4200
150mm increments	1200	1500	1800	2100	2400	2700	3000	3600	4000	4800
Height 'h'	79	95	110	134	150	172	172	209	209	209
Thickness	1.6	2	2	2	2	2	2.6	3.2	3.2	3.4
Total UDL 3:1 kn	12	14	19	21	21	26	27	27	26	27
Total UDL 19:1 kn	10	12	16	17	19	22	20	20	19	22

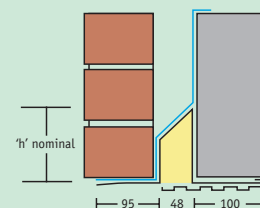

P/K-70

Manufactured length	600	1350	1650	1950	2250	2550
150mm increments	1200	1500	1800	2100	2400	3000
Height 'h'	98	98	106	130	142	168
Thickness	1.6	2	2	2	2	2
Total UDL 3:1 kn	12	14	18	21	21	27
Total UDL 19:1 kn	10	12	14	17	19	22

S/K-70

Manufactured length	600	1350	1650	1950	2250	2550
150mm increments	1200	1500	1800	2100	2400	3000
Height 'h'	98	98	106	130	142	168
Thickness	1.6	2	2	2	2	2
Total UDL 3:1 kn	12	14	18	21	21	27
Total UDL 19:1 kn	10	12	14	17	19	22

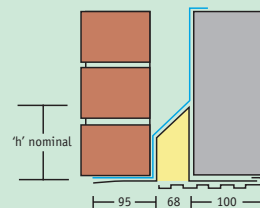

TIMBER FRAME LINTELS

T/K-50

Manufactured length	600	1800	2250	3150	4200
150mm increments	1650	2400	3000	4000	4800
Height 'h'	102	155	185	250	250
Thickness	2.6	2.6	2.9	3.2	3.4
Total UDL kn	5	8	9	12	12

For use with timber frame construction. The T/K lintel must be used in conjunction with lateral restraint clips and a tight fitting timber batten, as shown, to prevent twisting. The T/K range can be supplied to suit wider cavities (eg. specify T/K-70, T/K-90).

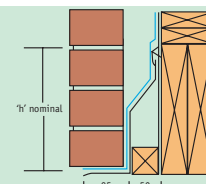

FULL ARCH LINTEL

Lintel Dimensions

- a – Clear span
- R – Radius
- c – End bearing

Wall Construction

- Outer leaf
- Cavity Width
- Inner Leaf

Plaster Key requirements

- Inside only
- Both sides
- None

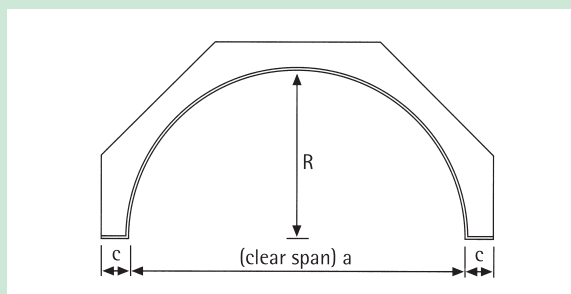
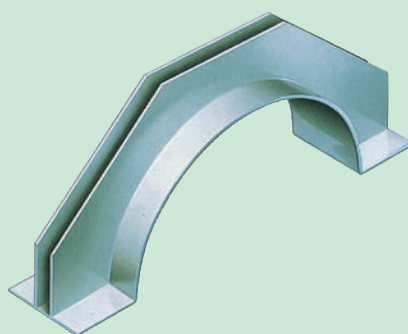

BOX LINTELS

BOX/K-100

Manufactured length	600	1650	1950	2550	2850	3750	4200
150mm increments	1500	1800	2400	2700	3600	4000	4800
Height 'h'	75	150	150	150	215	215	215
Thickness	2.0	1.6	2.0	2.0	2.6	2.6	2.6
Total UDL kn	18	18	25	20	35	30	24

Used to support internal or external openings with 100mm wide wall.

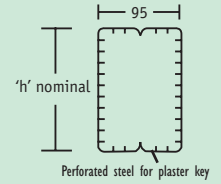

BOX/K-200

Manufactured length	600	1950	2550	2850	3750	4200
150mm increments	1800	2400	2700	3600	4000	4800
Height 'h'	150	150	150	215	215	215
Thickness	1.6	2.0	2.0	2.6	2.6	2.6
Total UDL kn	18	25	20	35	30	24

Used to support internal or external openings with 215mm wide wall.

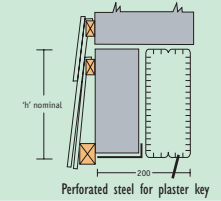

BOX/K-150

Manufactured length	600	1950	2550	2850	3750	4200
150mm increments	1800	2400	2700	3600	4000	4800
Height 'h'	150	150	150	215	215	215
Thickness	1.6	2.0	2.0	2.6	2.6	2.6
Total UDL kn	18	25	20	35	30	24

Used to support internal or external openings with 150mm wide wall.

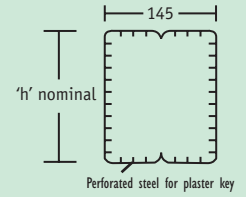

SOLID WALL LINTELS

INT/K

Overall length	900	1050	1100	1200
Max Span	700	850	900	1000
Total UDL kn with 150mm coursing	5	5	5	5
Total UDL kn with 225mm coursing	10	10	10	10

For standard loading conditions to support internal openings in 100mm and 75mm wide walls.

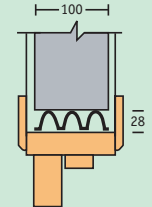

SW/K

Manufactured length	600	1350	1800	2250
150mm increments	1200	1650	2100	2700
Height 'h'	55	86	86	113
Thickness	2.6	2.6	2.9	3.2
Total UDL kn	6	8	8	10

For light duty loading conditions for 215mm solid wall construction. To achieve loading figures, lintel must be built in with block or brick work as shown and suitably propped during construction.

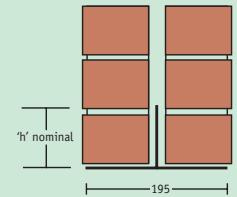

SB/K

Manufactured length	600	1500	1950	2400
150mm increments	1350	1800	2250	2700
Height 'h'	80	100	150	200
Thickness	3.2	3.2	3.2	3.2
Total UDL kn	2.5	5	7	8

For use to support the outer leaf of cavity wall construction. The SB/K lintel should be suitably propped during construction. The SB/K lintel can be supplied with no top bend (eg. specify ANG/K)

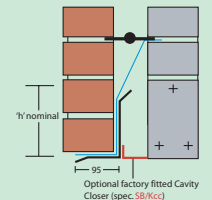

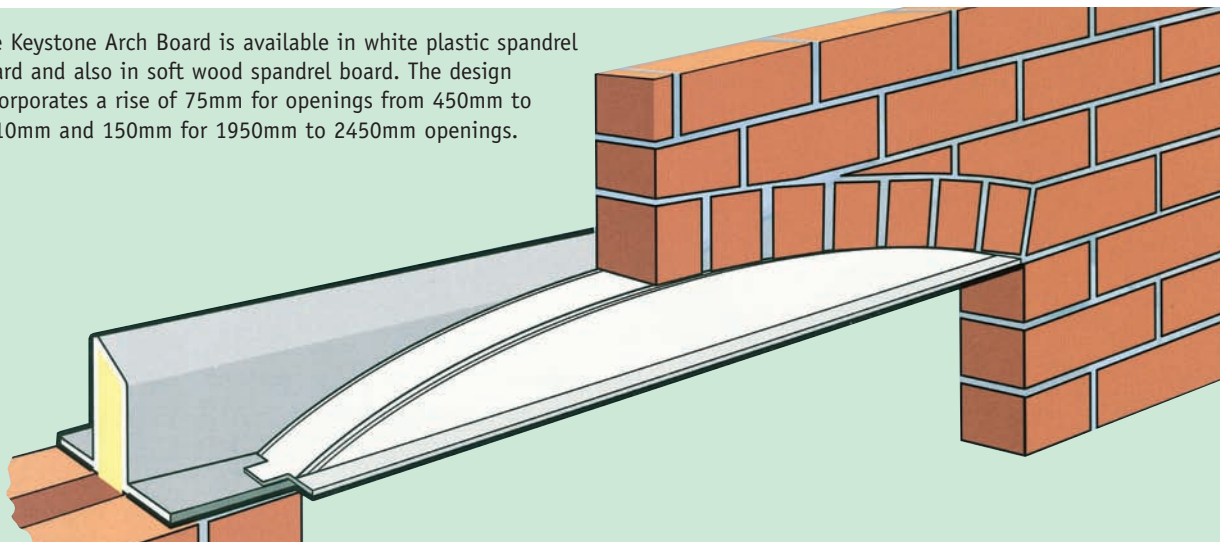

ARCH BOARD

The Keystone Arch Board is available in white plastic spandrel board and also in soft wood spandrel board. The design incorporates a rise of 75mm for openings from 450mm to 1810mm and 150mm for 1950mm to 2450mm openings.

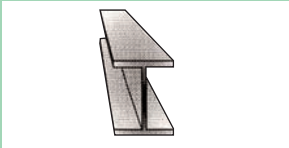
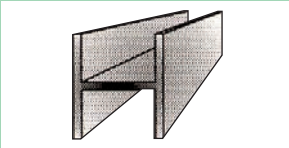
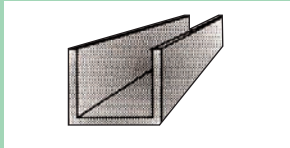

Steel Beams and Columns

UNIVERSAL BEAMS			UNIVERSAL COLUMNS			CHANNEL			ROLLED STEEL JOISTS		
											
Size mm (nominal)	Weight Kg/m	Size (ins)	Size mm (nominal)	Weight Kg/m	Size (ins)	Size mm (nominal)	Weight Kg/m	Size (ins)	Size mm (nominal)	Weight Kg/m	Size (ins)
127 x 76	13.00	5" x 3"	152 x 152	23.00	6" x 6"	50 x 25	4.00	2" x 1"	76 x 76	12.65	3" x 3"
152 x 89	16.00	6" x 3 1/2"		30.00		51 x 38	5.80	2" x 1 1/2"	102 x 102	23.07	4" x 4"
178 x 102	19.00	7" x 4"		37.00		76 x 38	6.70	3" x 1 1/2"	127 x 114	29.76	5" x 4 1/2"
203 x 102	23.00	8" x 4"	203 x 203	46.00	8" x 8"	76 x 51	9.34	3" x 2"	152 x 127	37.20	6" x 5"
203 x 133	25.00	8" x 5 1/2"		52.00		100 x 50	10.00	4" x 2"	203 x 152	52.09	8" x 6"
	30.00			60.00		125 x 65	15.00	5" x 2 1/2"			
254 x 102	22.00	10" x 4"		71.00		152 x 75	18.00	6" x 3"			
	25.00			86.00		150 x 90	24.00	6" x 3 1/2"			
	28.00		254 x 254	73.00	10" x 10"	180 x 75	20.00	7" x 3"			
254 x 146	31.00	10" x 5 1/2"		89.00		180 x 90	26.00	7" x 3 1/2"			
	37.00			107.00		200 x 75	23.00	8" x 3 1/2"			
	43.00		305 x 305	97.00	12" x 12"	200 x 90	30.00	8" x 3 1/2"			
305 x 102	25.00	12" x 4"		118.00		230 x 75	26.00	9" x 3"			
	28.00					230 x 90	32.00	9" x 3 1/2"			
305 x 127	37.00	12" x 5"				260 x 75	28.00	10" x 3"			
	42.00					260 x 90	35.00	10" x 3 1/2"			
	48.00					300 x 90	41.00	12" x 3 1/2"			
305 x 165	40.00	12" x 6 1/2"				300 x 100	46.00	12" x 4"			
	46.00										
	54.00										
356 x 127	33.00	14" x 5"									
	39.00										
356 x 171	45.00	14" x 6 1/2"									
	51.00										
	57.00										
	67.00										
406 x 140	39.00	16" x 5 1/2"									
	46.00										
406 x 178	54.00	16" x 7"									
	60.00										
	67.00										
	74.00										
457 x 191	67.00	18" x 7 1/2"									
	74.00										
	89.00										

CONCRETE PRESTRESSED LINTELS

65X100/100X65

Length	Code	Pack Qty	Approx weight Kgs
450	P100045	48	308
600	P100060	48	411
750	P100075	24	257
900	P100090	21	308
1050	P100105	24	360
1200	P100120	24	411
1350	P100135	16	308
1500	P100150	16	342
1650	P100165	16	377
1800	P100180	16	411
2100	P100210	16	479
2400	P100240	16	548
2700	P100270		39
3000	P100300		43
3300	P100330		47
3600	P100360		51

CATNIC STEEL LINTELS

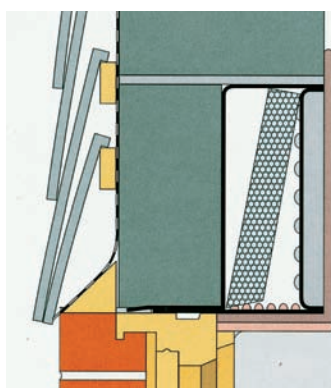

CN81 lintel



External solid wall CN71 lintel